

Zoom Meeting

Wongso   Vilvi Lim   Michael Sam   Linda Wati   stella sung   Putra Lukita

Remove Spotlight   02:10:50

Janson Hendryli

Mute   Stop Video   Security   Participants 21   Chat   Share Screen   Record   Reactions   Apps   Leave

Participants (21)

- Linda Wati (Host)
- Andy's iPhone (Co-host)
- Michael Sam (Co-host)
- Vilvi Lim (Co-host)
- Andy Pang
- Carlene Lim
- Hertanto Tan
- Indra Tandiady
- Prajna Tara
- Putra Lukita
- Shelly Putri
- stella sung
- Vera Kartika Winata
- Verdy S | Building Contractor | 08127...

Invite   Mute All   More



Vilvi Lim

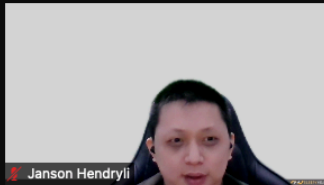

Janson Hendryli



Wongso



Michael Sam



Hertanto Tan

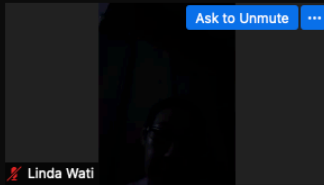

Linda Wati

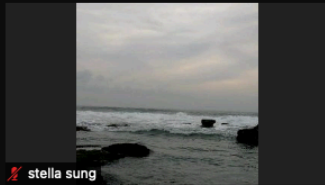

stella sung



Putra Lukita



Verdy S | Building Contractor | 08127118153

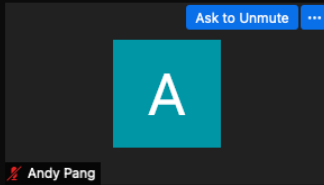

Andy Pang

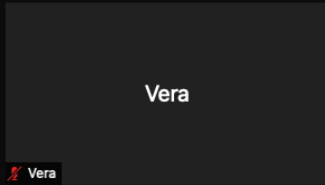

Vera

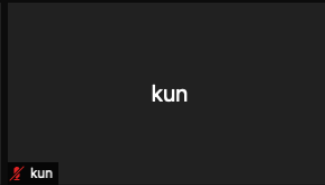

kun



Indra Tandiyady

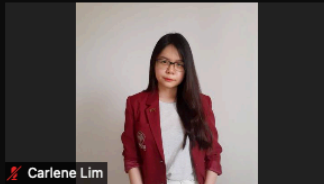

Carlene Lim

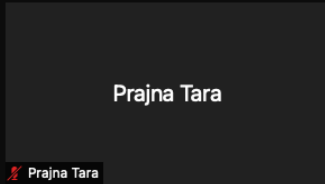

Prajna Tara

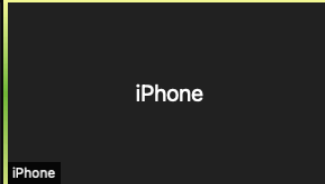

iPhone



Andy's iPhone



Shelly Putri

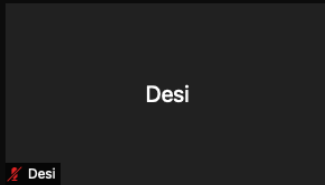

Desi



Vera Kartika Winata

Search

- Linda Wati (Host)
- Aj Andy's iPhone (Co-host)
- MS Michael Sam (Co-host)
- VL Vilvi Lim (Co-host)
- W Wongso (Co-host)
- i iPhone
- A Andy Pang
- Carlene Lim
- D Desi
- HT Hertanto Tan
- IT Indra Tandiyady
- k kun
- PT Prajna Tara
- PL Putra Lukita
- SP Shelly Putri
- stella sung
- V Vera

Leave

Invite

Mute All

More

Unmute

Stop Video

Security

Participants 20

Chat 6

Share Screen

Record

Reactions

Apps



# Keamanan Data Pribadi di Era Digital

Janson Hendryli

Apakah pernah mengalami?

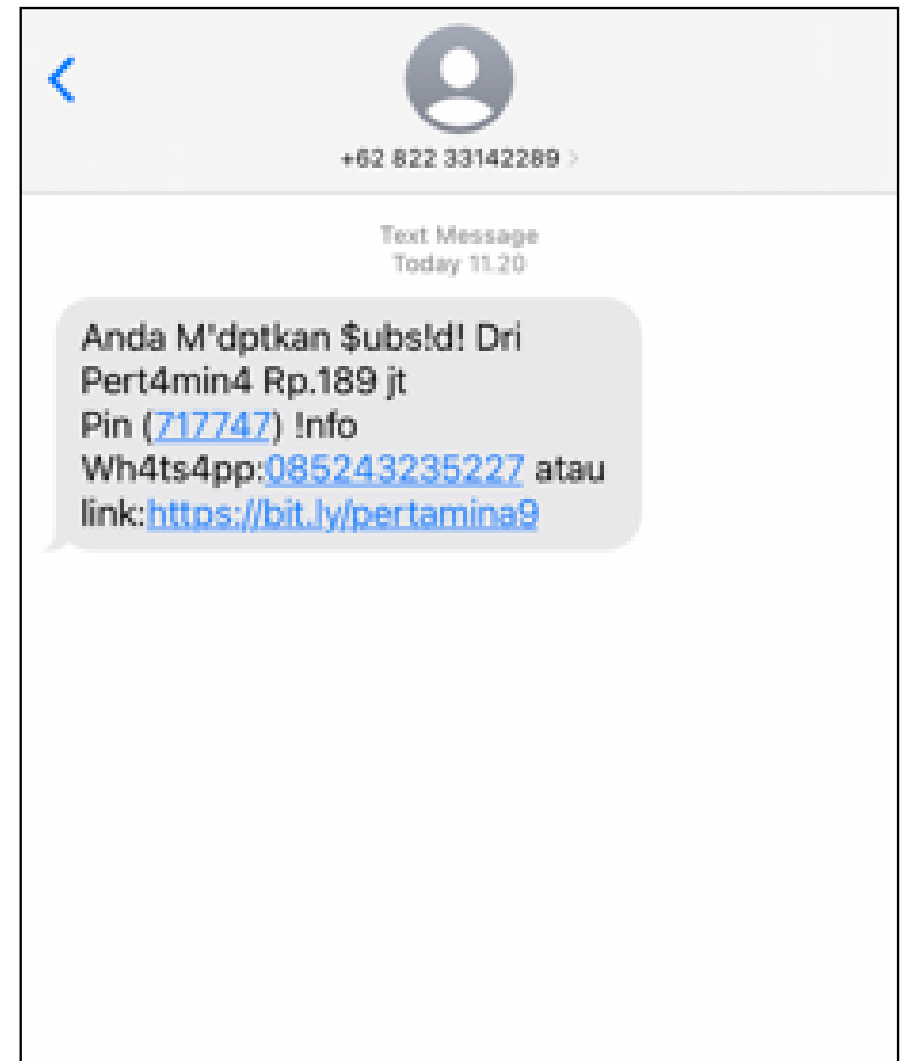

Apakah pernah mengalami?



# Apakah pernah mengalami?

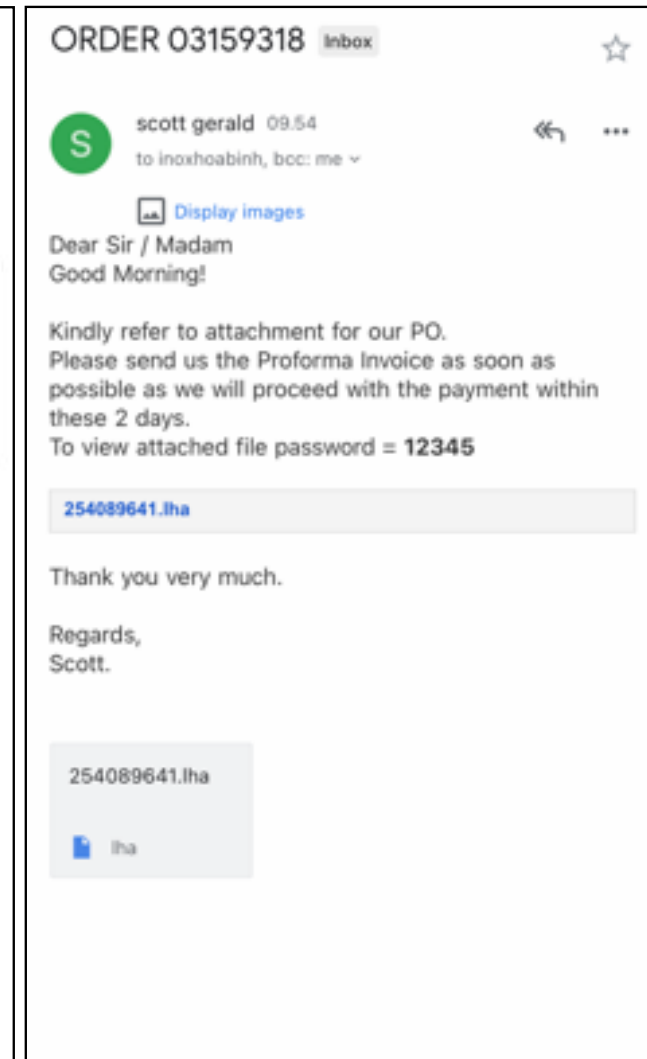
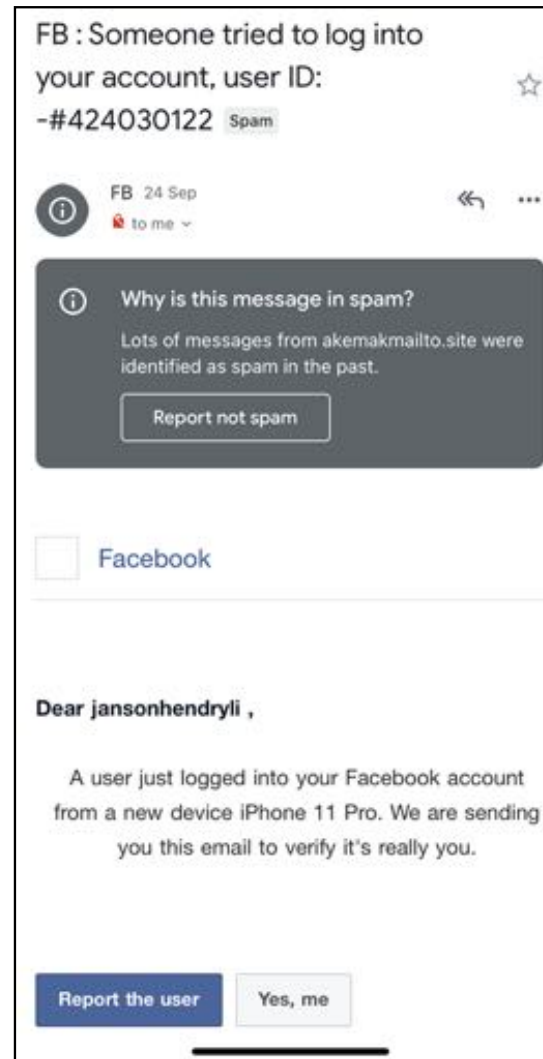

“Whatever can go wrong, will go wrong”

*–Murphy's Law*

# Cek Rekening

<https://cekrekening.id>

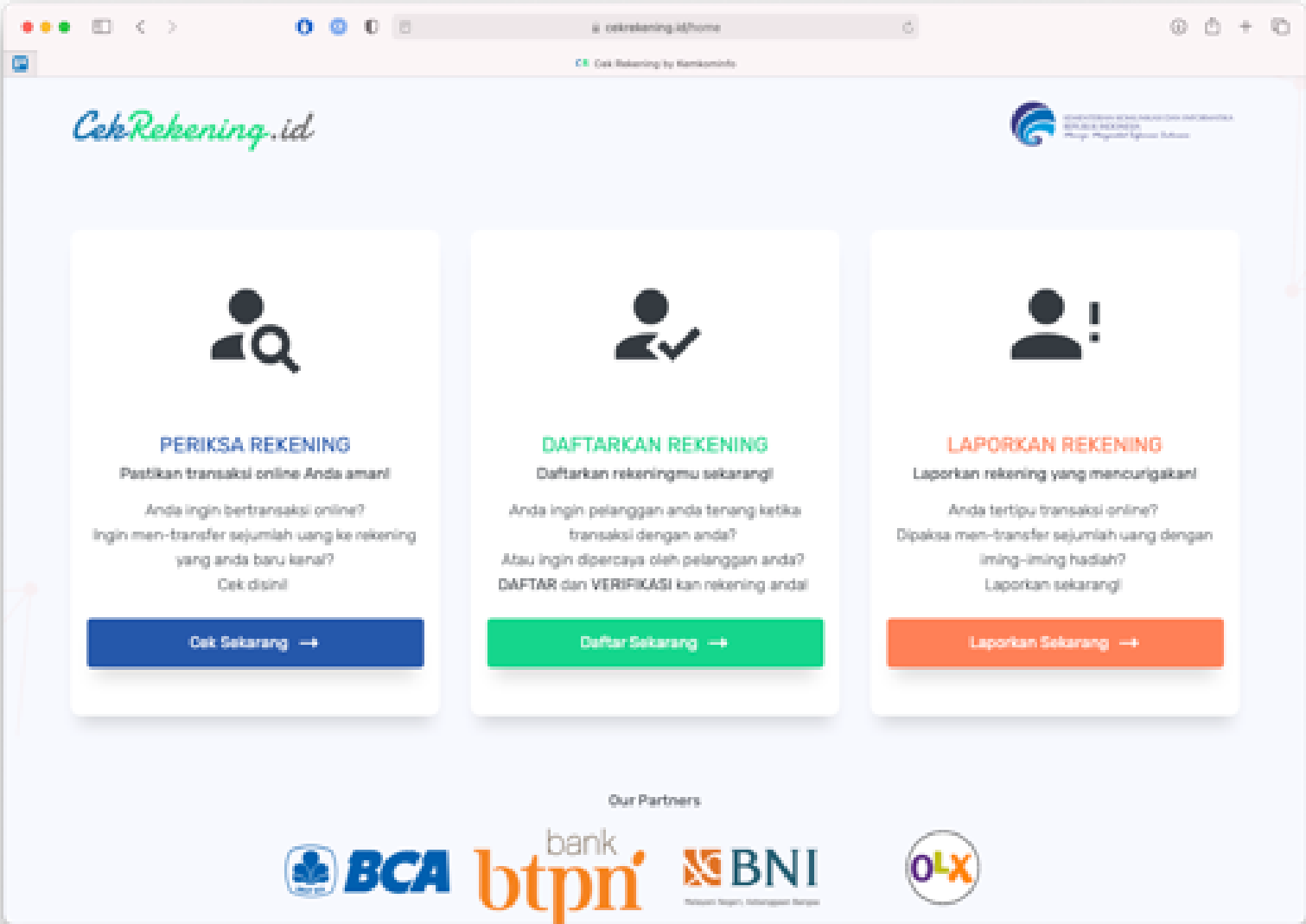



Berikan watermark pada foto KTP



Sumber: KOMPAS.TV ([https://www.youtube.com/watch?v=A\\_RMZH\\_UVss](https://www.youtube.com/watch?v=A_RMZH_UVss))

# Berikan watermark pada foto KTP

Bisa menggunakan aplikasi di smartphone

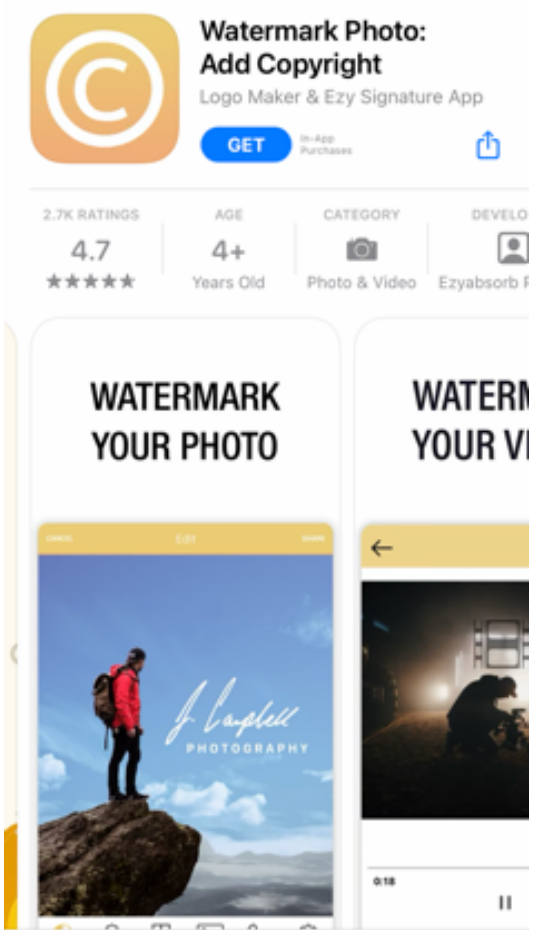

## CARA MEMBUAT WATERMARK PADA SCAN KTP 2.0

PROVINSI DKI JAKARTA  
JAKARTA SELATAN

NDK : 1234567890123456

Nama	: JOHN DOE
Tempat/Tgl. Lahir	: JAKARTA, DD-MM-YYYY
Jenis Kelamin	: LAKILAKI
Alamat	: LOREN IPULU DOLOR SIT AMET 021101
RT/RW	: LOREN IPULU LOREN IPULU
Kecamatan	: LOREN IPULU
Agama	: BELUM KAWIN
Status Perumahan	: BELUM KAWIN
Pekerjaan	: BELUM KAWIN
Kewarganegaraan	: BELUM KAWIN
Berkas Hingga	: BELUM KAWIN

JAKARTA SELATAN  
18-02-2020

- 1 Buka aplikasi untuk mengedit foto
- 2 Tambahkan teks yang berisi keterangan scan
- 3 Atur ukuran dan posisi teks agar menutupi informasi penting
- 4 Turunkan *opacity* atau transparansi teks agar informasi dan watermark-nya sama-sama masih bisa terbaca

KEMENTERIAN KOMUNIKASI DAN INFORMATIKA  
REPUBLIK INDONESIA

Sumber: Kemenkominfo  
<https://www.instagram.com/p/CT4j1Smh41J/>

# Hati-hati saat memberikan *permission* pada apps di smartphone

Pastikan permission yang diminta sesuai dengan fungsi aplikasi.

Permission yang perlu diperhatikan:

- ▶ Camera
- ▶ Contacts
- ▶ Location
- ▶ Microphone
- ▶ Phone
- ▶ SMS
- ▶ Storage

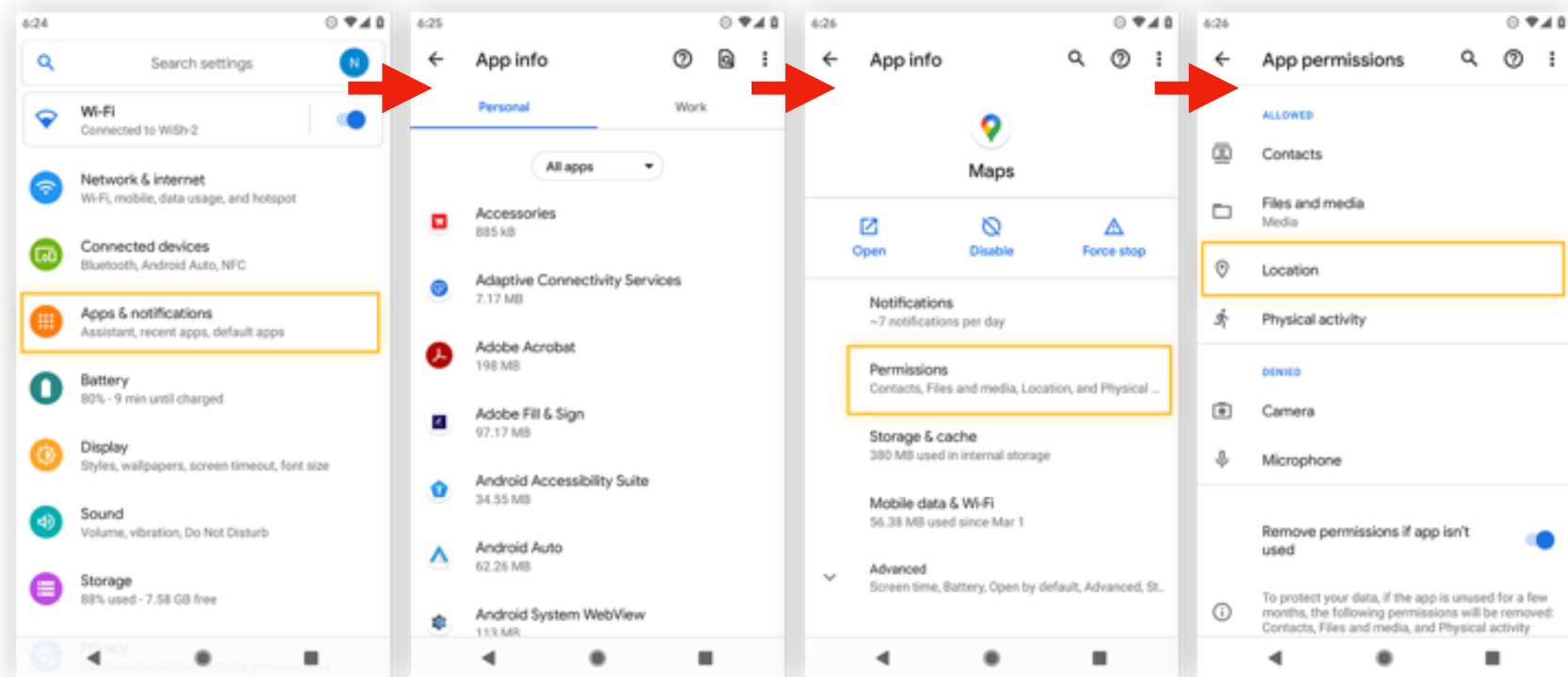

# Aplikasi GetContact

Cek nomor telepon yang menghubungi kita

Alternatif lain:

- ▶ TrueCaller

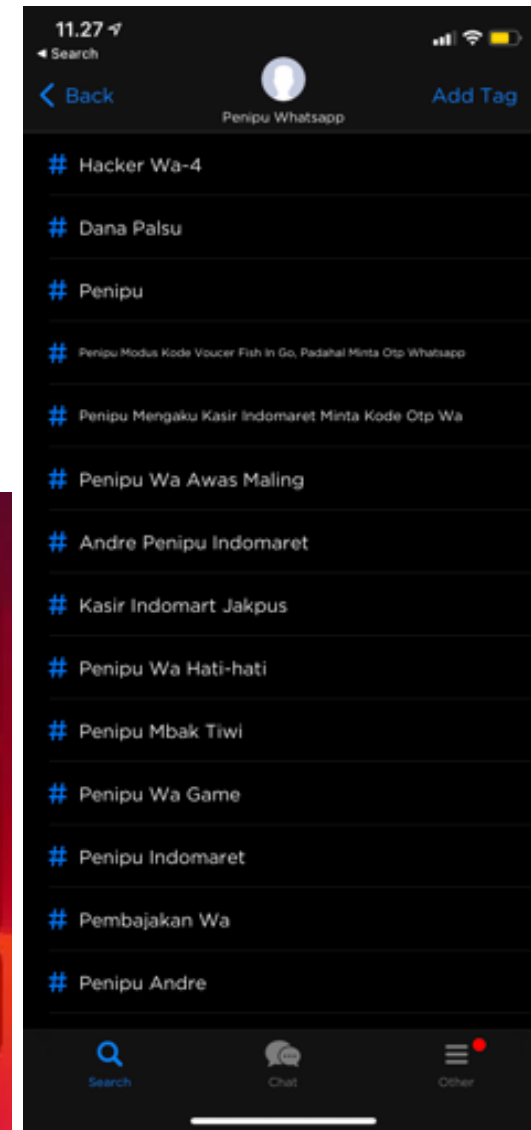

# Cek kebocoran data

<https://haveibeenpwned.com>

Home / Tekno / Internet

## Data 15 Juta Pengguna Diduga Bocor, Tokopedia Sebut Ada Upaya Pencurian

Kompas.com - 02/05/2020, 22:06 WIB

BAGIKAN:    

Komentar 



TECH • LINKEDIN

## Massive data leak exposes 700 million LinkedIn users' information

BY CHRIS MORRIS

June 30, 2021 10:43 PM GMT-7

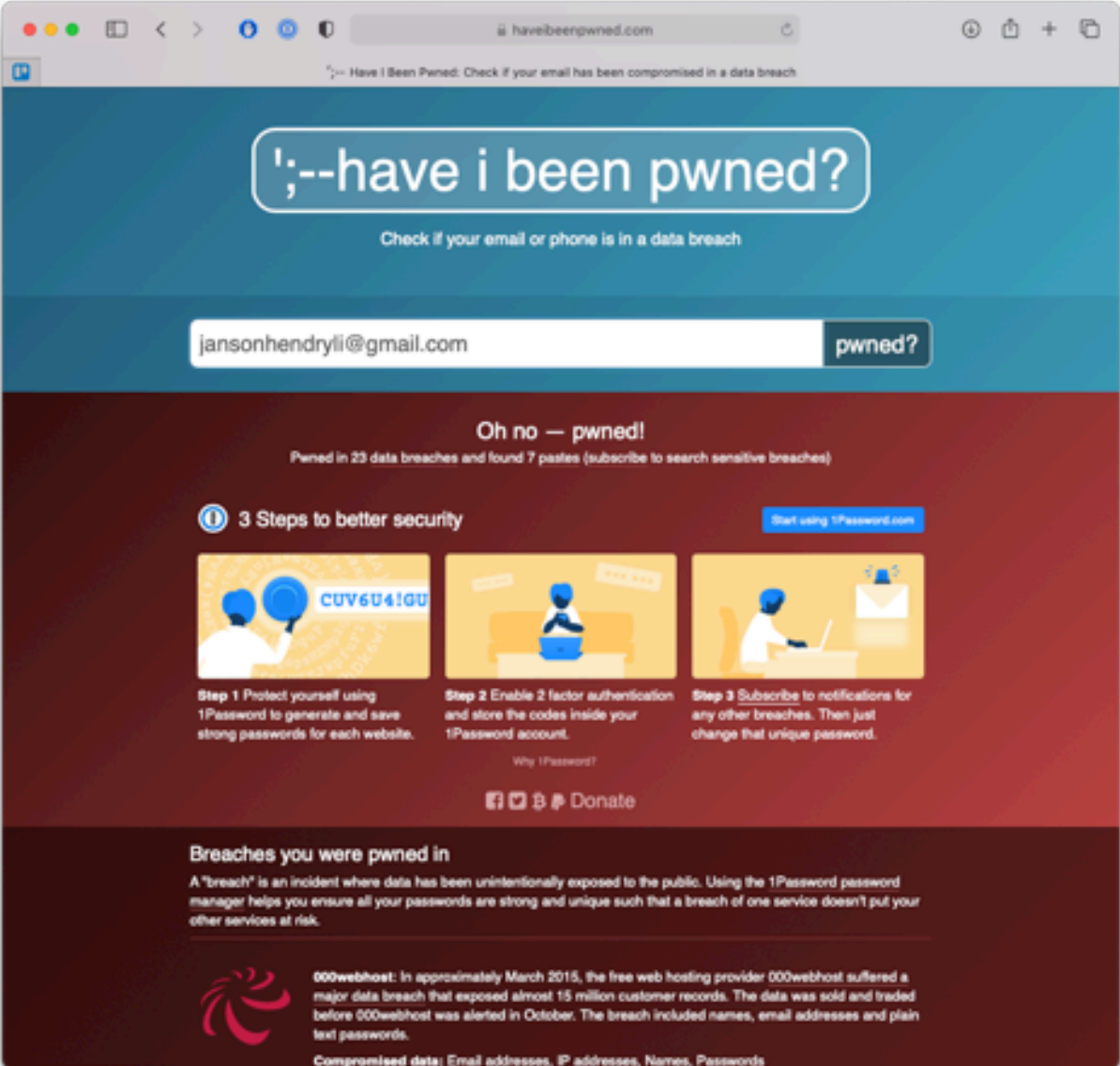

Have I Been Pwned: Check if your email has been compromised in a data breach

# '--have i been pwned?

Check if your email or phone is in a data breach

Oh no — pwned!  
Pwned in 23 data breaches and found 7 pastes (subscribe to search sensitive breaches)

### 3 Steps to better security

[Start using 1Password.com](#)

- Step 1** Protect yourself using 1Password to generate and save strong passwords for each website.
- Step 2** Enable 2 factor authentication and store the codes inside your 1Password account.
- Step 3** Subscribe to notifications for any other breaches. Then just change that unique password.

Why 1Password?

[Facebook](#) [Twitter](#) [Bitcoin](#) [Donate](#)

### Breaches you were pwned in

A "breach" is an incident where data has been unintentionally exposed to the public. Using the 1Password password manager helps you ensure all your passwords are strong and unique such that a breach of one service doesn't put your other services at risk.

 **000webhost:** In approximately March 2015, the free web hosting provider 000webhost suffered a major data breach that exposed almost 15 million customer records. The data was sold and traded before 000webhost was alerted in October. The breach included names, email addresses and plain text passwords.

**Compromised data:** Email addresses, IP addresses, Names, Passwords

# Password yang kuat

- ▶ Minimum 8 karakter
- ▶ Campuran dari huruf kecil, huruf besar, dan simbol
- ▶ Hindari kata yang ada di kamus dan informasi pribadi
- ▶ Jangan ditulis di atas kertas

**Password Strength Chart** **SANDSTORM**<sup>IT</sup>  
power on

This is based on the average brute forcing (botnet) power in 2019.

<b>123456</b> <small>Top 10,000 password</small>	<b>0.20 milliseconds</b>	<b>Unsafe</b>
<b>qwerty123456</b> <small>Longer "common" password</small>	<b>13 hours</b>	<b>Unsafe</b>
<b>ITFunSom3times</b> <small>Longer password with numbers</small>	<b>48 thousand years</b>	<b>Risky</b>
<b>ITISfun\$0m3times!</b> <small>Longer password with numbers and special characters</small>	<b>13 trillion years</b>	<b>Good</b>
<b>imusingalongpasswordtoday</b> <small>Even Longer password</small>	<b>913 trillion years</b>	<b>Better</b>
<b>imu\$ingalongpa\$\$word+oday!</b> <small>Even Longer password with numbers and special characters</small>	<b>2 octillion years</b>	<b>Best</b>

Please Note: These passwords are for demonstration purposes ONLY and are not to be used.

# Password Manager

- ▶ 1Password
- ▶ LastPass
- ▶ NordPass
- ▶ Dashlane

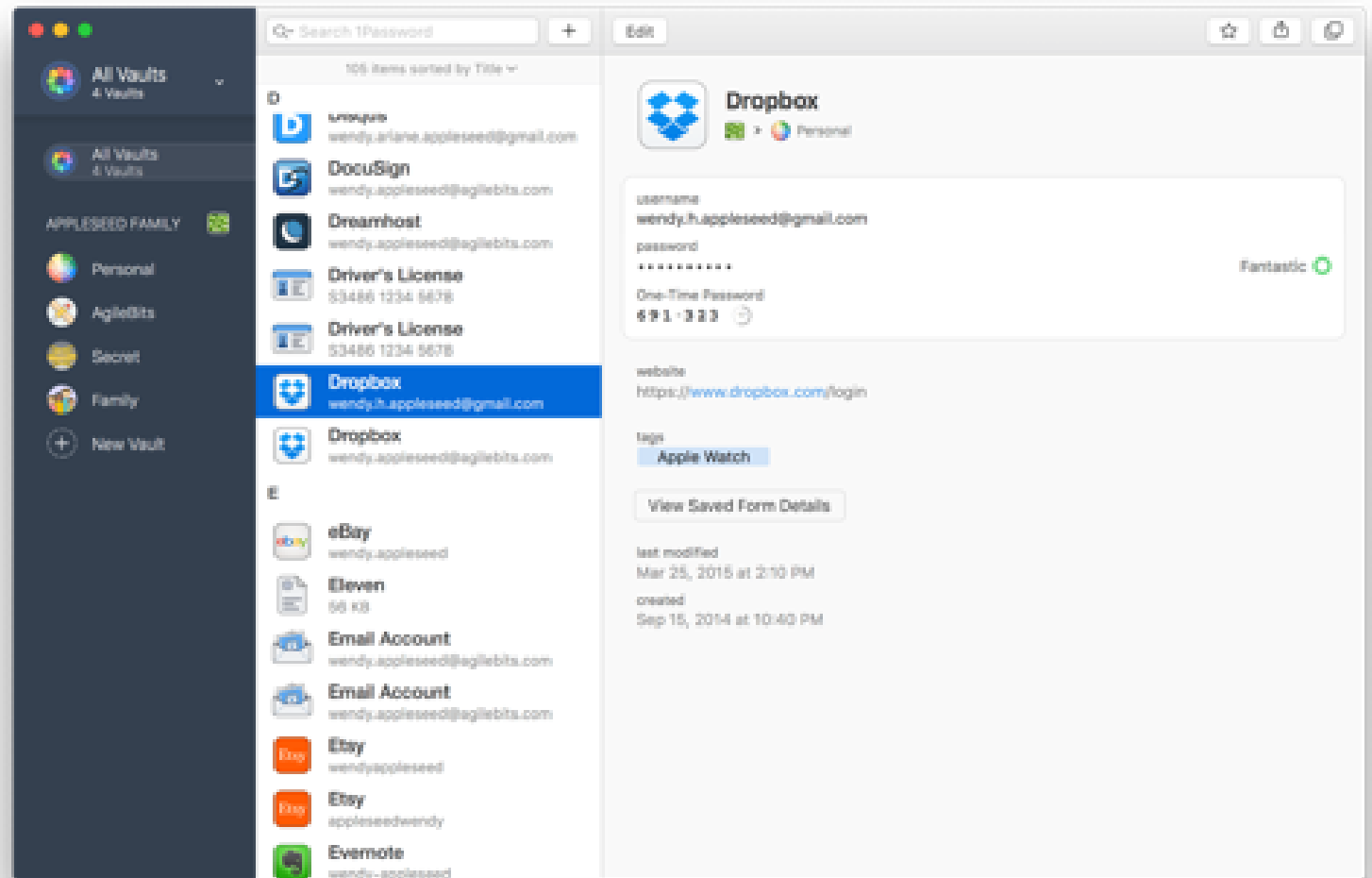

# Aktifkan two-factor authentication (2FA)

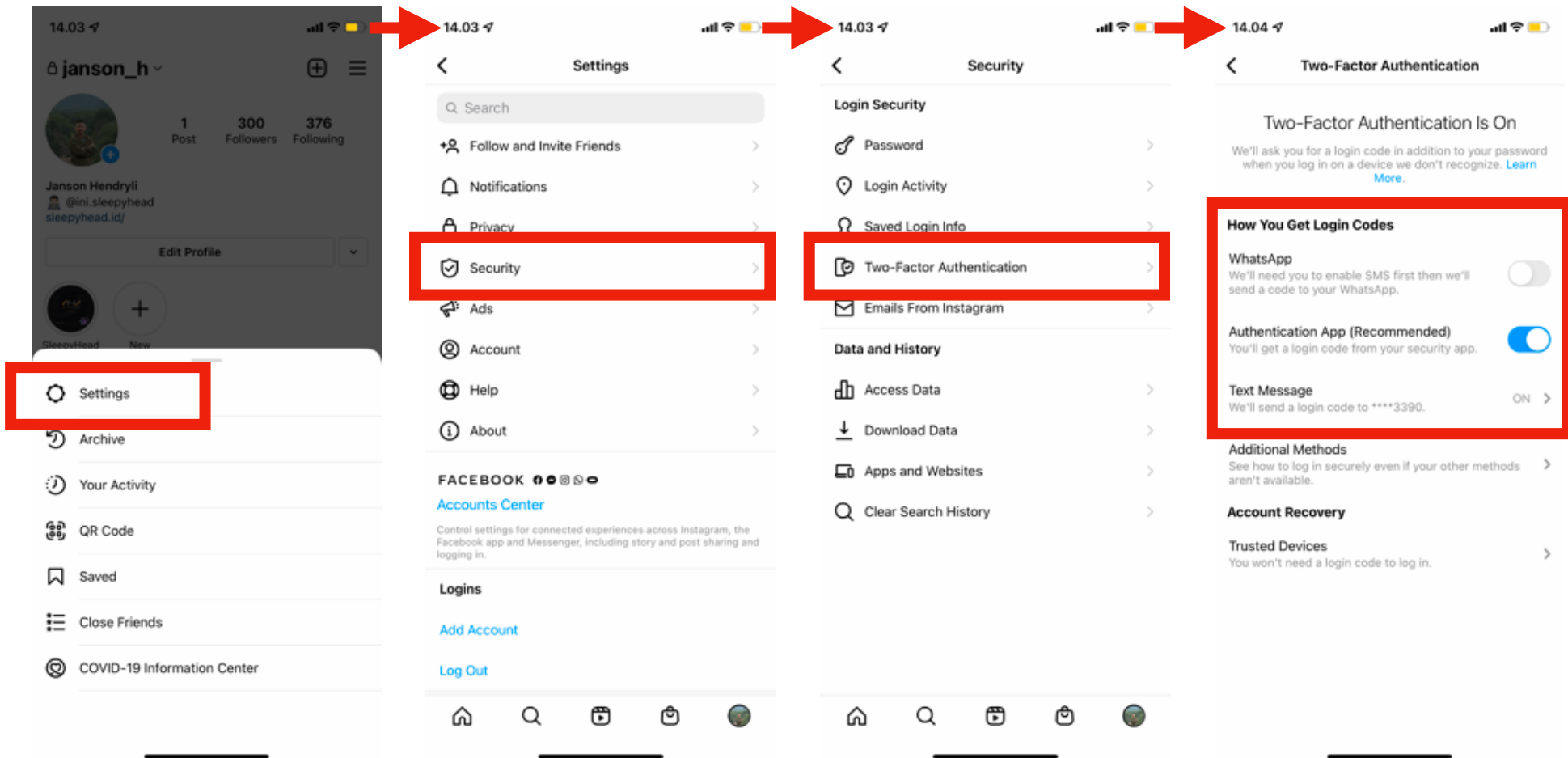





# Phising

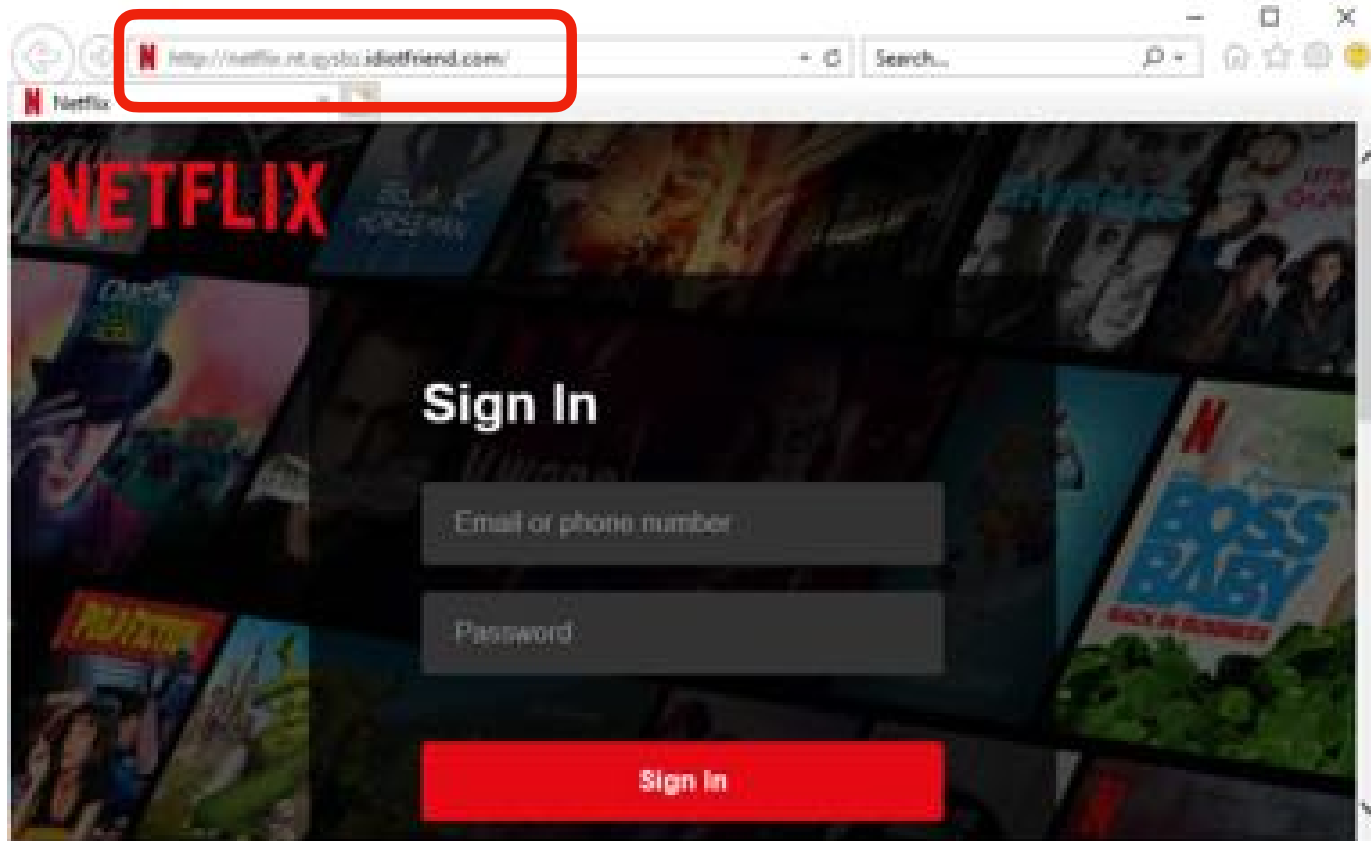

# Cara menghindari phishing scams

- ▶ Jangan sembarangan login
- ▶ Jangan sembarangan klik link atau buka file yang diberikan orang
- ▶ Jangan mengakses data sensitif melalui wifi atau komputer publik

# Cara menghindari phishing scams

- ▶ Jangan sembarangan login
  - ▶ Fake website (cek alamat website tersebut)

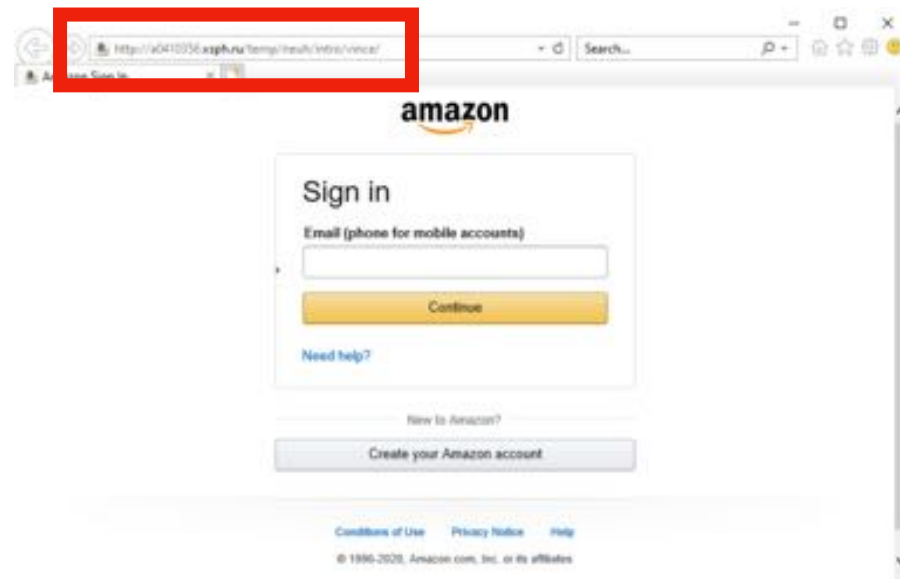
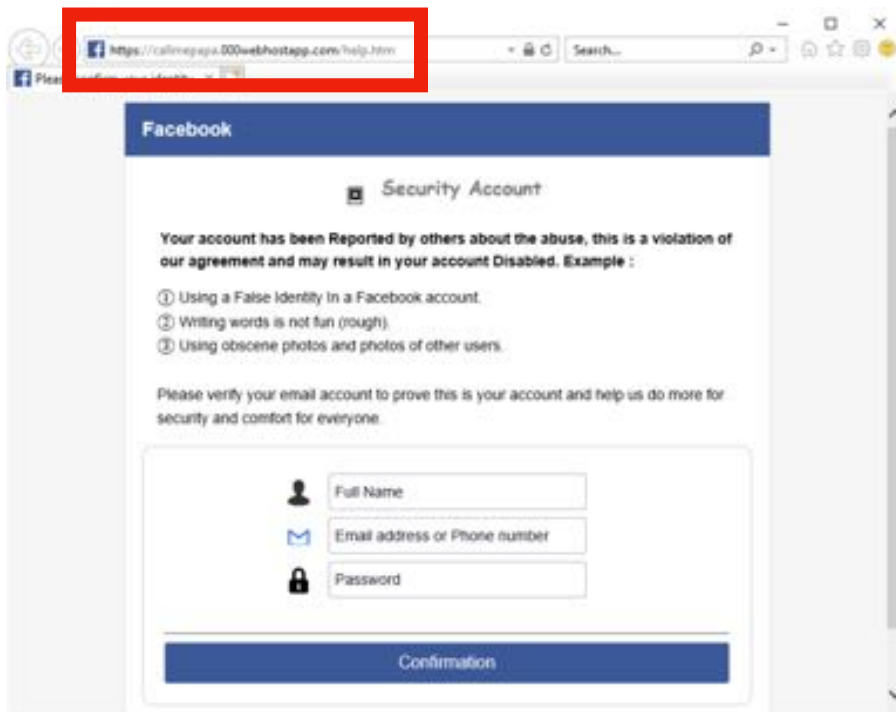

**Cukup berbahaya karena mencoba menyamar sebagai email yang legitimate**

**Tidak dianggap spam oleh Gmail**

Nama pengirim aneh  
Tidak terenkripsi

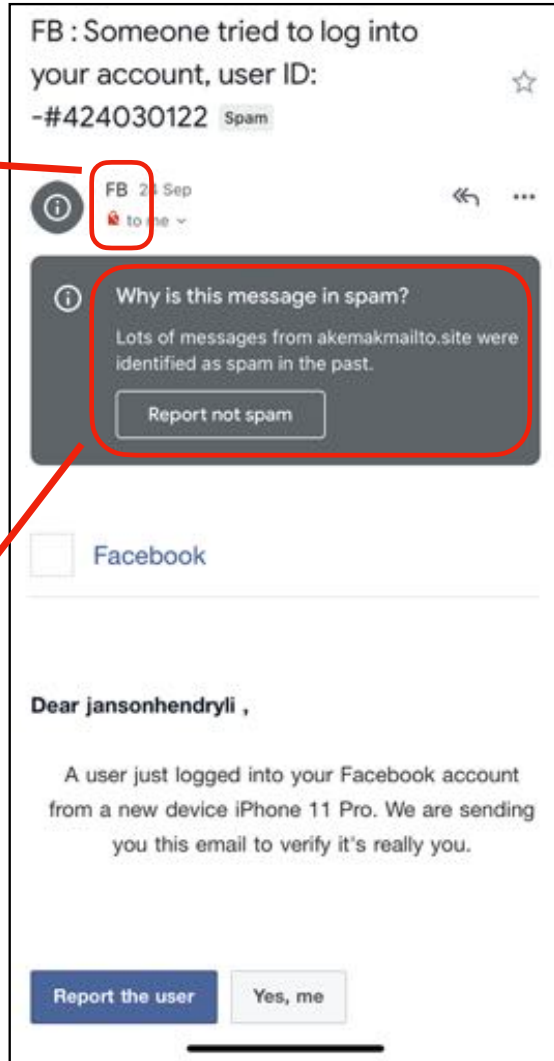

Dianggap spam oleh Gmail

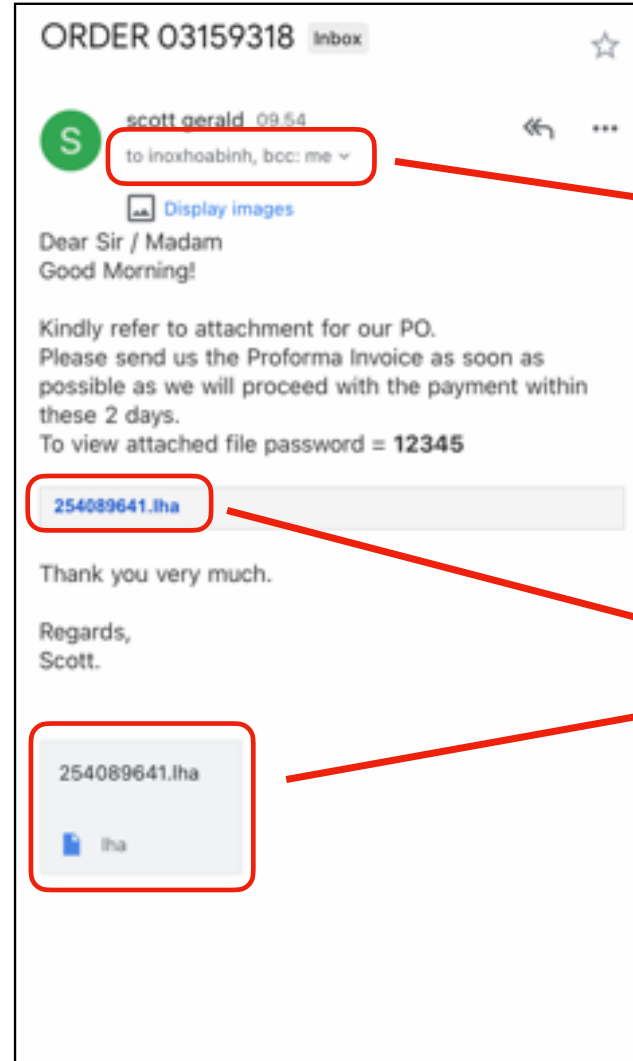

Tidak dikirim langsung ke email saya (pakai bcc)

Jenis file tidak dikenal  
Umumnya: PDF, Doc, Docx

Gunakan common sense  
Tidak merasa request PO dari LN  
Aneh jika PO memiliki password  
Tidak kenal dengan scott gerald

► **Jangan sembarangan klik link atau buka file yang diberikan orang**

# Jangan mengakses data sensitif melalui wifi atau komputer publik

- ▶ Jangan mengakses data sensitif, misalnya internet banking, email pribadi, dll
- ▶ Lebih baik menggunakan paket data/personal hotspot
- ▶ Gunakan VPN
- ▶ Nyalakan 2FA

